

ASSEMBLY INSTRUCTIONS

ITEM NO : D818-10T/D818-10B

RECTANGULAR DINING TABLE

Thank you for purchasing this quality product. Be sure to check all packing material carefully for small parts that may have come loose inside the carton during shipment.

Step 1: Place Table Leg B, Table Leg Support C, Center Apron D and Support Block F on a carpeted surface. Attach Table Leg B with Center Apron D by insert (G, J & K), Table Leg Support C with Center Apron D by insert (K, J & H), Support Block F and the bottom of Table Leg B by insert (K, J & I).

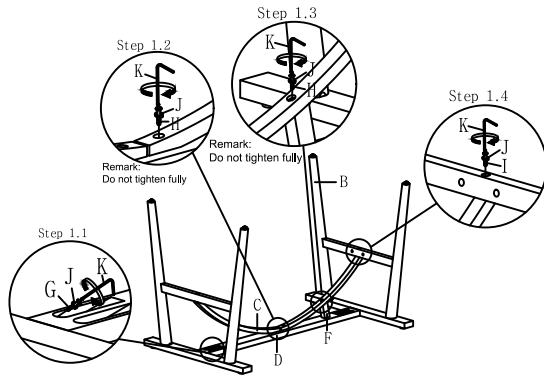

Step 2: Remember tighten fully as shown as picture step 2.1 and step 2.2. Then screw in the Support Block F by insert (M).

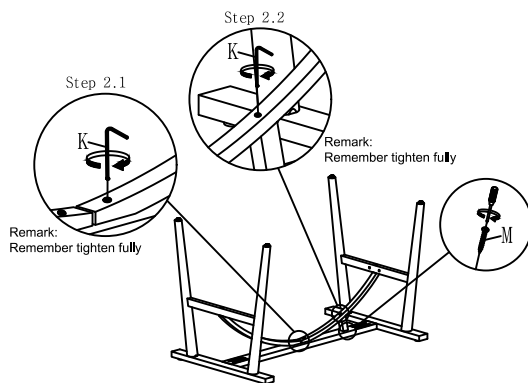

Step 3: Attach Center Rail E with Table Leg B by insert (G, J & K)

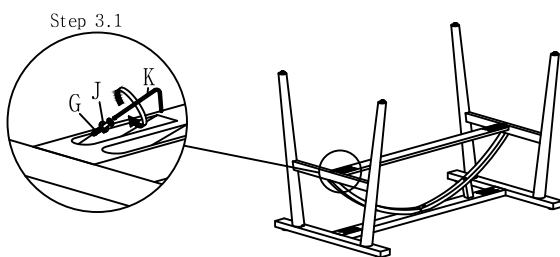

Step 4: Attach Glass Top A to Table Leg B by inserting (N & O).

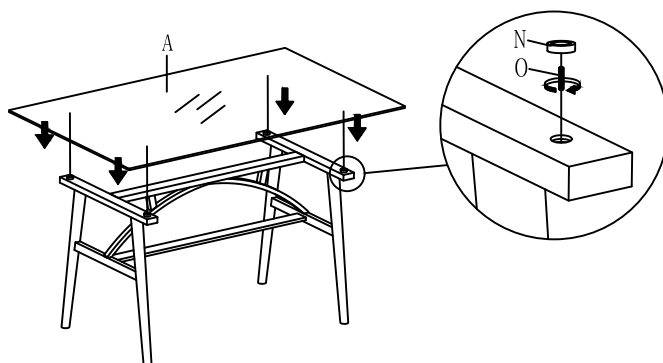

PARTS LIST :

| NO. | Description | Sketch | Quantity |
|-----|-------------------|--------|----------|
| A | GLASS TOP | | 1pc |
| B | TABLE LEG | | 2pcs |
| C | TABLE LEG SUPPORT | | 2pcs |
| D | CENTER APRON | | 1pc |
| E | CENTER RAIL | | 1pc |
| F | SUPPORT BLOCK | | 2pcs |

HARDWARE LIST :

| NO. | Description | Sketch | Quantity |
|-----|---|--------|----------|
| G | JCBC SCREW M6 x 50MM | | 8pcs |
| H | JCBC SCREW M6 x 35MM | | 4pcs |
| I | JCBC SCREW M6 x 25MM | | 2pcs |
| J | SPRING WASHER 5/16" | | 14pcs |
| K | M4 ALLEN KEY | | 1pc |
| L | WOOD DOWEL DIA 8 x 35MM | | 2pcs |
| M | PAN HEAD SCREW M5 x 32mm | | 2pcs |
| N | ALUMINIUM DIS WITH RUBBER RING DIA 30MM x T10MM | | 4pcs |
| O | JCBC M6 x 25MM | | 4pcs |

Step 5: Finally, Assembly Completed!

